

T3 Smart Plug P1

Model: PA-01TH



Wi-Fi Connection



Set Timer



Remote control

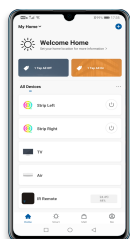

**download
T3 Smart App**

◇ Product Overview

T3 smart plug has 3 pin plug and 3 holes in 1 phase which is support in Thailand standard for using. The smart plug sockets have shutter, Line and Neutron sockets for safety. Moreover, the smart plug support using via application.



The smart plug is connected to the Internet via a WiFi wireless network or Bluetooth. You can control the socket on/off status from any place with a network connection via a smartphone. You can control any electrical device plugged into this socket from the local network or remote network, such as fans, lights, water heaters, fountains, etc. The socket has timing function and reservation function. This smart socket can control the state of the switch through the language after connecting to Google home.

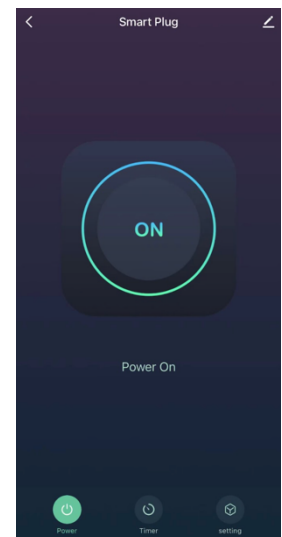

Function	Description
Mobile phone remote control	In the case that the mobile phone and the socket are connected to the Internet, the smart socket can be remotely controlled in the network environment by the mobile phone APP.
Manual switch in hand	Switching on/off status by clicking the switch button on the socket
Timing function	Mobile APP with timing control switch function (can be set to repeat the week).
Online upgrade	When a new version of the app comes out, you can upgrade it online in the app to add more features.
Smart sharing	Can share to friends or family
Intelligent configuration	Support Android and iOS Smart configuration

◆ Specifications

Appearance process	
Dimensions	54mm*53mm*53mm
Shell material	PC+ABS, UL94V0, GWIT 875°C/0.75MM
Shell surface	Color White
Plug copper	Brass / nickel plating
Copper sleeve copper parts	Phosphor bronze / nickel plating / thickness≥0.5mm
Performance parameter	
Input voltage	AC100~240V (1 Phase)
Input frequency	50/60Hz
Maximum load current	Resistive, maximum 10A
WIFI standard	WIFI 802.11 b/g/n
WIFI frequency	2.4GHz
Bluetooth	Support
Security Mechanism	WAP/WAP2
Encryption type	WEP/TKIP/AES
Working power consumption	< 1.3W
Standby power consumption	< 0.7W
Indicator light	Blue LED
Use environment	
Work Temperature°C	-20~50
Work Humidity R.H.	< 80%
Storage Temperature°C	-20~60
Storage Humidity R.H.	< 80%
Input voltage	AC100~240V (1 Phase)

Warnings and precautions

1. The plug must be fully inserted into the wall socket.
2. Do not use conductors or other tools to insert into the jack.
3. If there is radio frequency interference during operation, the socket may not work.
- 4, can only be used indoors.
5. Please use it in a dry place. Do not use it in a damp place such as a bathroom.
- 6, please ensure that the electricity is safe, the resistive load current can not be higher than 10A.
7. Keep out of reach of children.

◇ Package Content

Smart Plug P1*1

User manual*1

◇ How to connect product with Application

1. Use your smartphone to scan QR code, or search “T3 Smart” app in Google Play Store or APP Store to download and install. This Application support android and IOS.

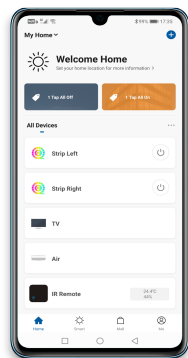

download
T3 Smart App

2. Create an account with your mobile number and authentication code.

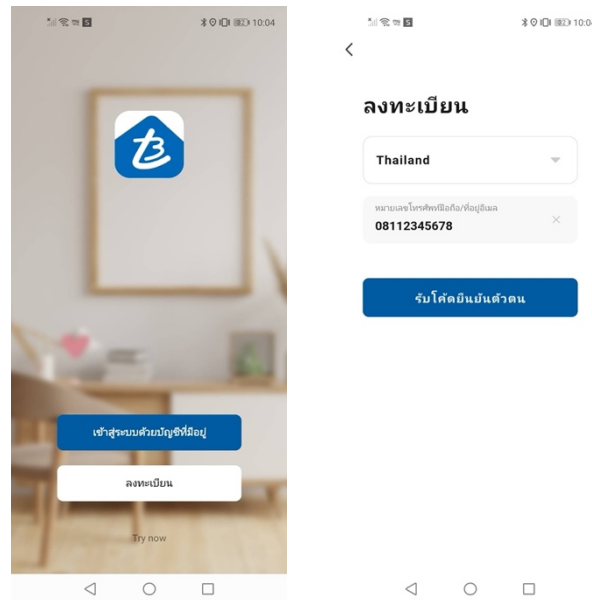

3. Open "T3 Smart "APP, press “+” or “Add Device” in the main screen then click "Socket" and choose "Smart Plug” to add in EZ mode or just click “Add” at Discover device for quick adding. Then choose Wi-Fi 2.4 GHz and fill in password then press next.

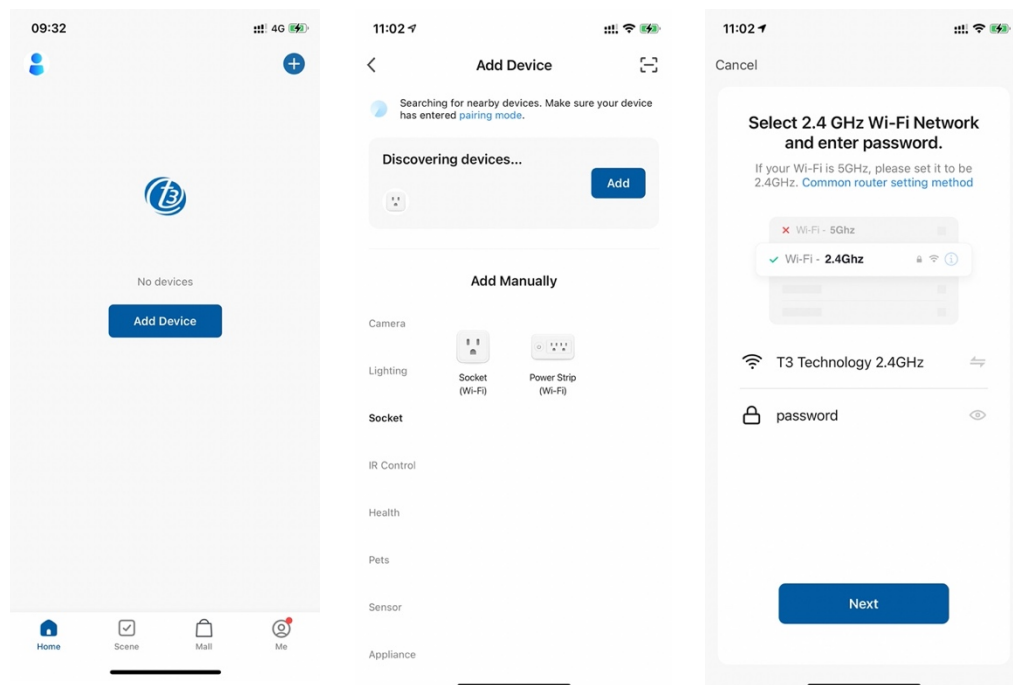

4. Follow the app instructions to connect the Smart Plug.

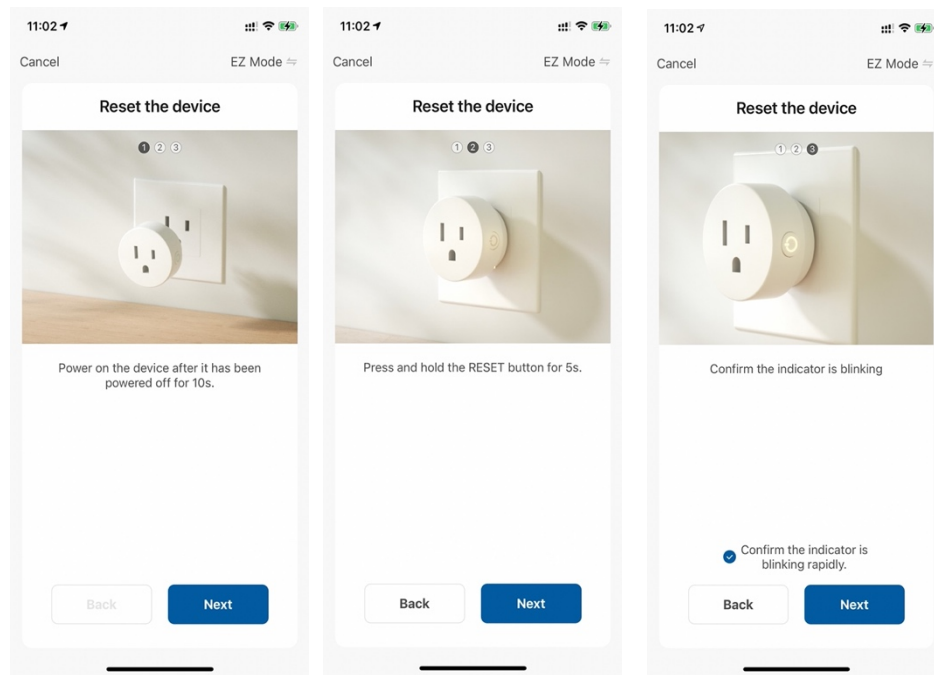

5. Once the configuration is completed, the indicator light will turn to solid blue and the device will be add to the device list.

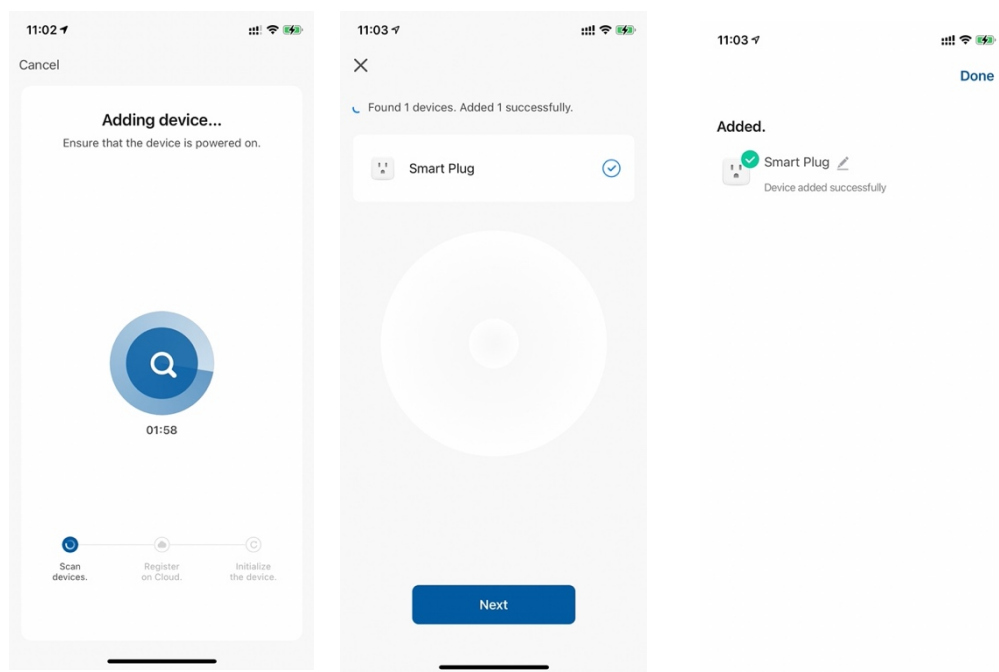

◇ How to use Application

Now you can control the Smart Plug through T3 Smart APP. Smart Plug will be on Device List. When you want to setting device you can just set it on setting pages.

- Tap “Smart Plug” icon to control it on Application.

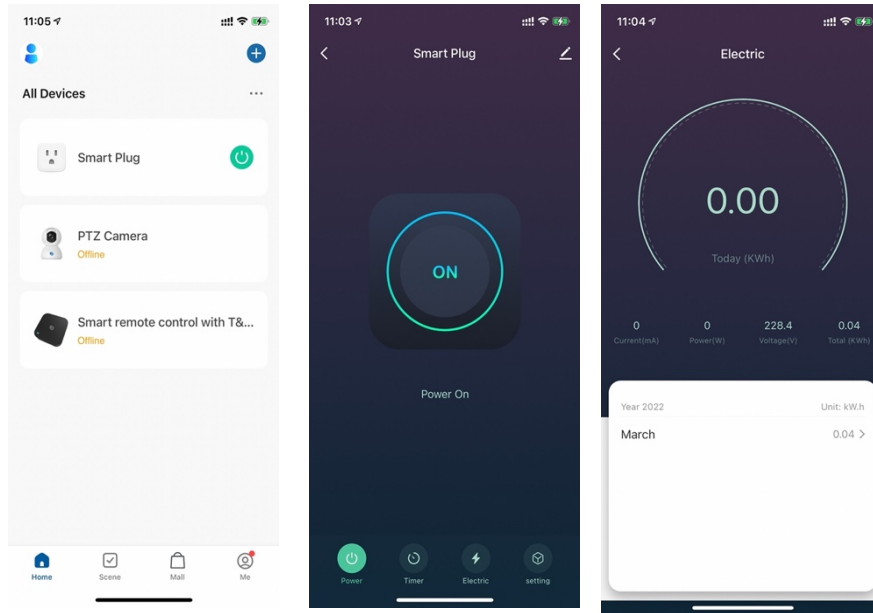

The application can turn on and off smart plug, Set Timer, Check energy consumption and General setting for smart plug. For the function of Set Timer, you can have many choices for setting time such as Countdown (Picture 1), Schedule (Picture 2), Circulate (Picture 3), Random (Picture 4), Inching (Picture 5), and Astronomical (Picture 6).

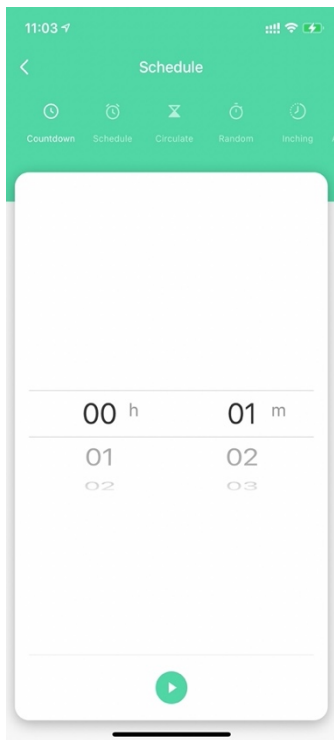

Picture 1

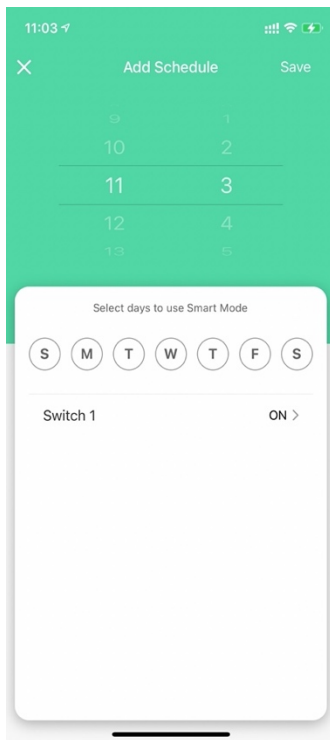

Picture 2

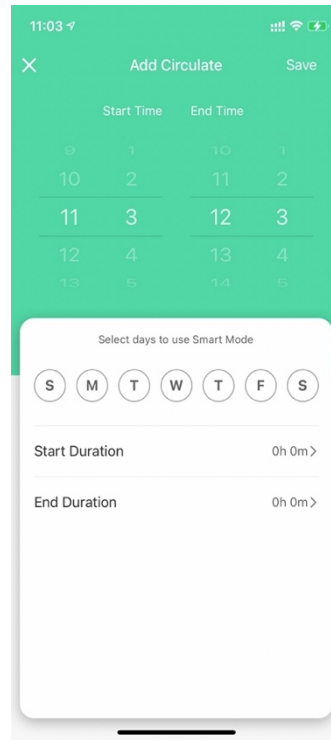

Picture 3

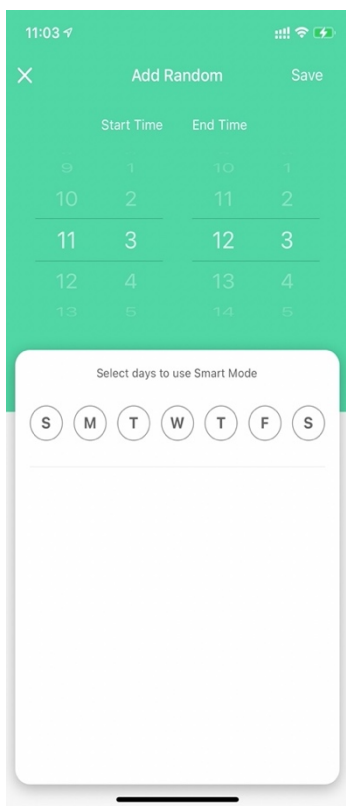

Picture 4

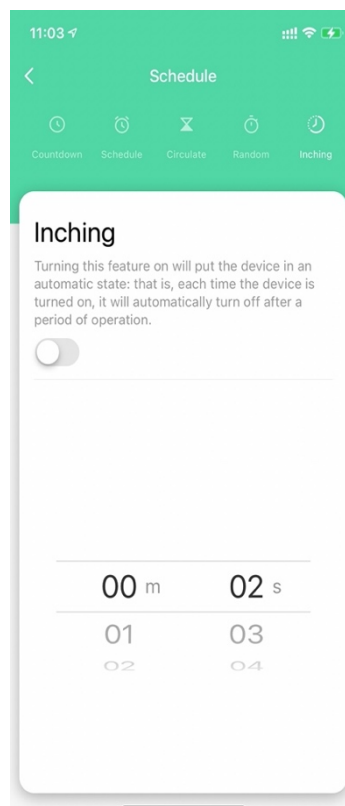

Picture 5

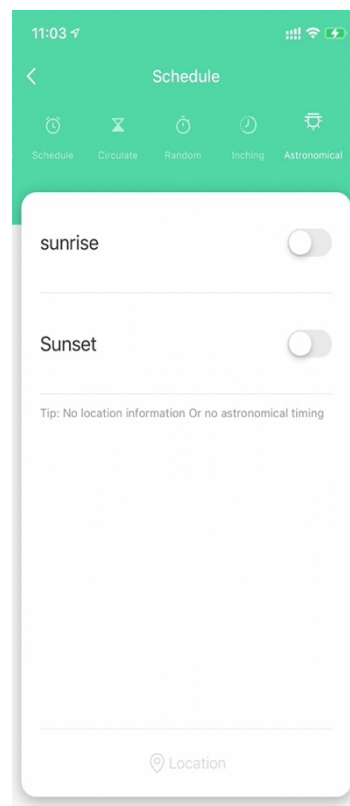

Picture 6